

NOTES

1. STRAINER BODY: FIBERGLASS CONSTRUCTION USING ISOPHTHALIC POLYESTER RESIN AND A .100" THK. CORROSION LINER USING ONE LAYER C GLASS AND TWO LAYERS CHOPPED STRAND MAT.
2. LID: FRP WITH ACRYLIC VIEWPORT
3. TOGGLE BOLTS: STAINLESS STEEL
4. HAND KNOBS: ABS WITH BRASS INSERTS
5. O-RING: ETHYLENE PROPYLENE
6. BASKET: 316 STAINLESS STEEL WEDGE WIRE, 3/16" SQUARE OPENING

-INLET AND OUTLET FLANGES SHALL HAVE 150#
ANSI STANDARD DRILL PATTERNS

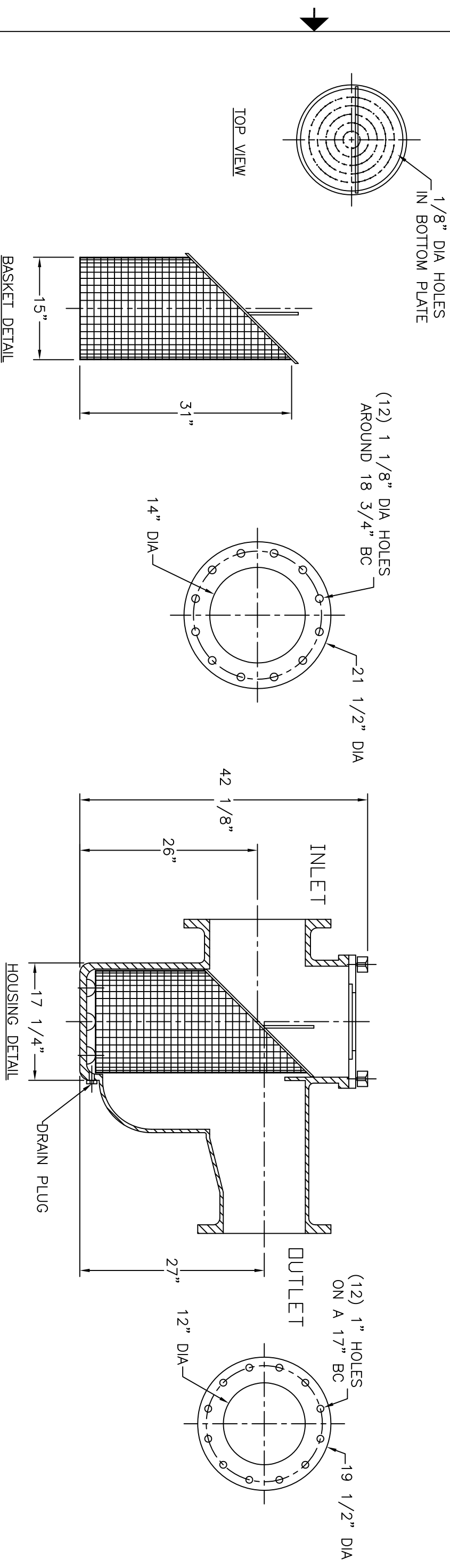

CERTIFIED FOR PRODUCTION									
TOLERANCES UNLESS OTHERWISE SPECIFIED									
MACHINED DIMENSIONS:									
XX		± .020		FINISH: 125/					
X.XX		± .010		ANGLES: ± 2					
X.XXX		± .005		RADII: ± .03					
FRACTIONAL DIMENSIONS:									
1/X		± 1/8							
REMOVE ALL BURRS AND BREAK ALL SHARP EDGES: .016 x 45°									
REV		DESCRIPTION							
DATE									
SCALE: NTS		DATE: 05/21/20		Sheet: 1		OF 1			
SIZE		DWN BY: S JV		DWG NO.		REV			
B		CHK BY:		M-0212		R0			
14" x 12" FO STYLE ECCENTRIC REDUCING BASKET STRAINER									
MER-M MADE®						PO BOX 306 DENMARK, SC 29042 P:803-793-4263 F:803-793-4265			